

# Knottingley and Ferrybridge

## Masterplan Consultation

1

The Council has appointed Lichfields, Systra and Gillespies as it's technical team to prepare a Masterplan that delivers the aspirations for the area.

**We have got exciting plans to regenerate and develop the area. We have prepared a masterplan and would love to get your feedback about how we can improve your town centre, your neighbourhoods and your employment opportunities.**

The masterplan is informed by research into existing conditions in the area and this has helped us understand the area's strengths and opportunities, as well as its current weaknesses and challenges. Once approved, the Masterplan will sit alongside the Council's emerging Wakefield Local Plan and will guide development in Knottingley and Ferrybridge.

The area included within the Masterplan is shown to the right:



A successful place with a great sense of community where local people prosper, underpinned by the opportunities created by thriving businesses. The towns industrial and sporting heritage, civic pride, and beautiful open spaces and waterways provide opportunities to grow and improve the town for everyone's benefit.

### How to get involved



#### Talk to us today

Representatives from the technical team and the Council are at the consultation events and are happy to discuss the proposals with you.



#### Fill out our Questionnaire

Fill out the questionnaire available here today. Please leave this in the comment boxes available.



#### Comment online

You can also complete the questionnaire online in your own time by visiting: [www.knottingley-masterplan.uk](http://www.knottingley-masterplan.uk)



#### Any Questions

contact us in your own time via [masterplan2020@lichfields.uk](mailto:masterplan2020@lichfields.uk)

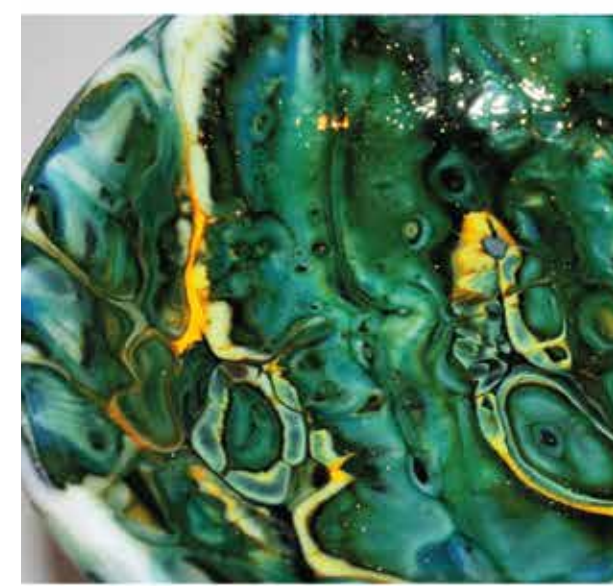

LICHFIELDS

GILLESPIES

SYSTRA

wakefieldcouncil



# Knottingley and Ferrybridge

## Masterplan Consultation

2

### Draft Masterplan

The options have been developed with an understanding of the existing area and in connection with the Council and its emerging Wakefield Local Plan.



#### Retention

of green spaces & agricultural fields to the south east.



#### Integration

of existing green corridors within the proposed development.



#### Increased Accessibility

between new and existing areas, including a proposed link to the south of the M62.



#### 130 hectares of land

130 ha of land within the south east area, accommodating approximately 2,600 new homes.



#### 296 hectares

296 ha of employment land within the west, south and east of the masterplan area.



#### Regeneration

of Hill Top, Knottingley



#### A new link road

to provide connectivity to the A645 in the west and Weeland Road in the east.

### The Vision



### Masterplan

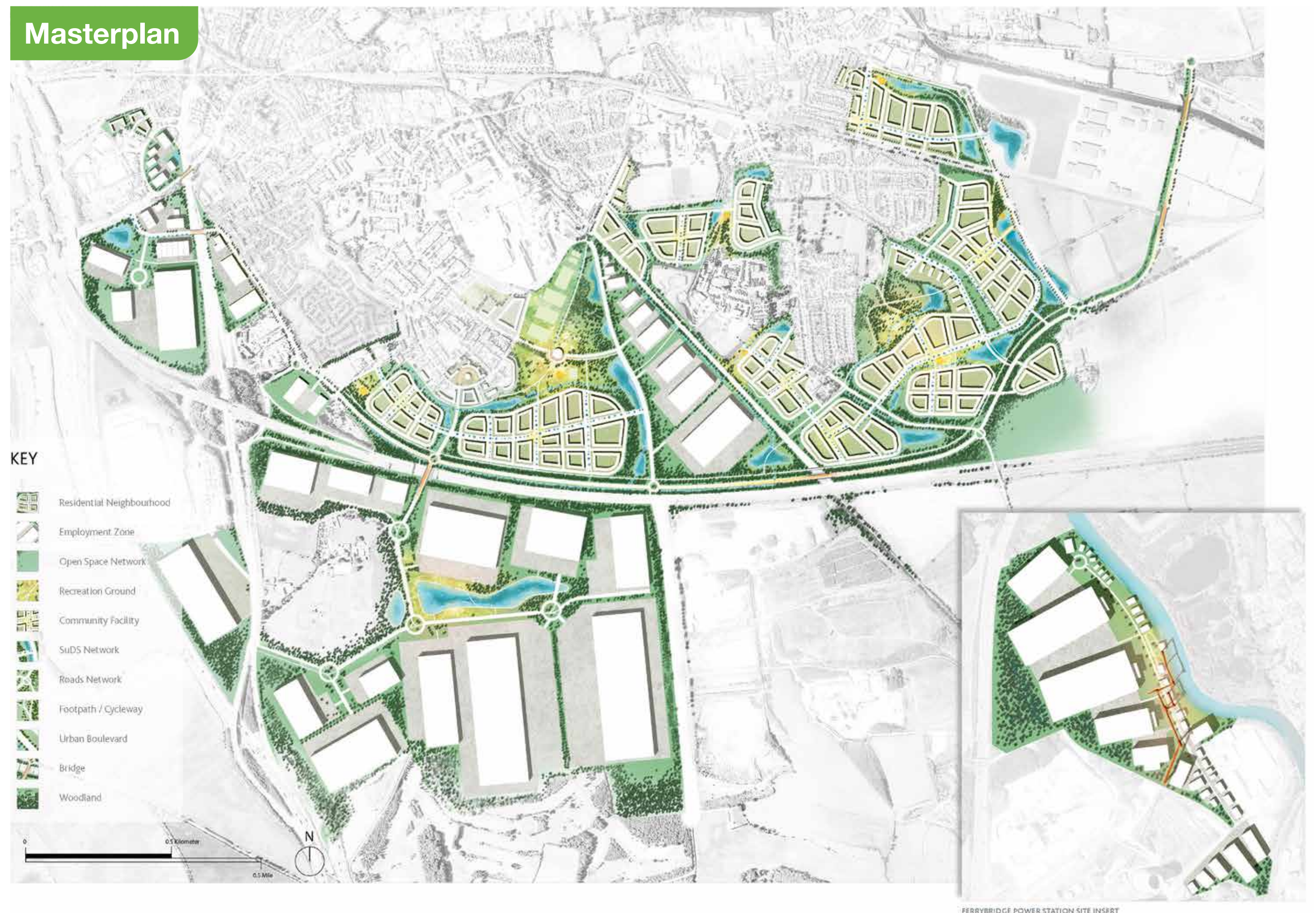

### Typical Neighbourhood





# Knottingley and Ferrybridge Masterplan Consultation

3

## Hill Top

The Masterplan proposes to regenerate Hill Top so it becomes a destination to suit the community's needs and becomes an attractive environment.



At present, Hill Top is served by a parade of shops, a Morrisons and Lidl supermarkets. The parade of shops has a limited offer and is in decline. Available car parking is limited, with most provided on the shop frontages. Hill Top is heavily trafficked by commercial vehicles accessing local industrial sites. Improved access between the railway station, shops and supermarkets is required and there is a need to provide for improved access for pedestrians and cyclists.

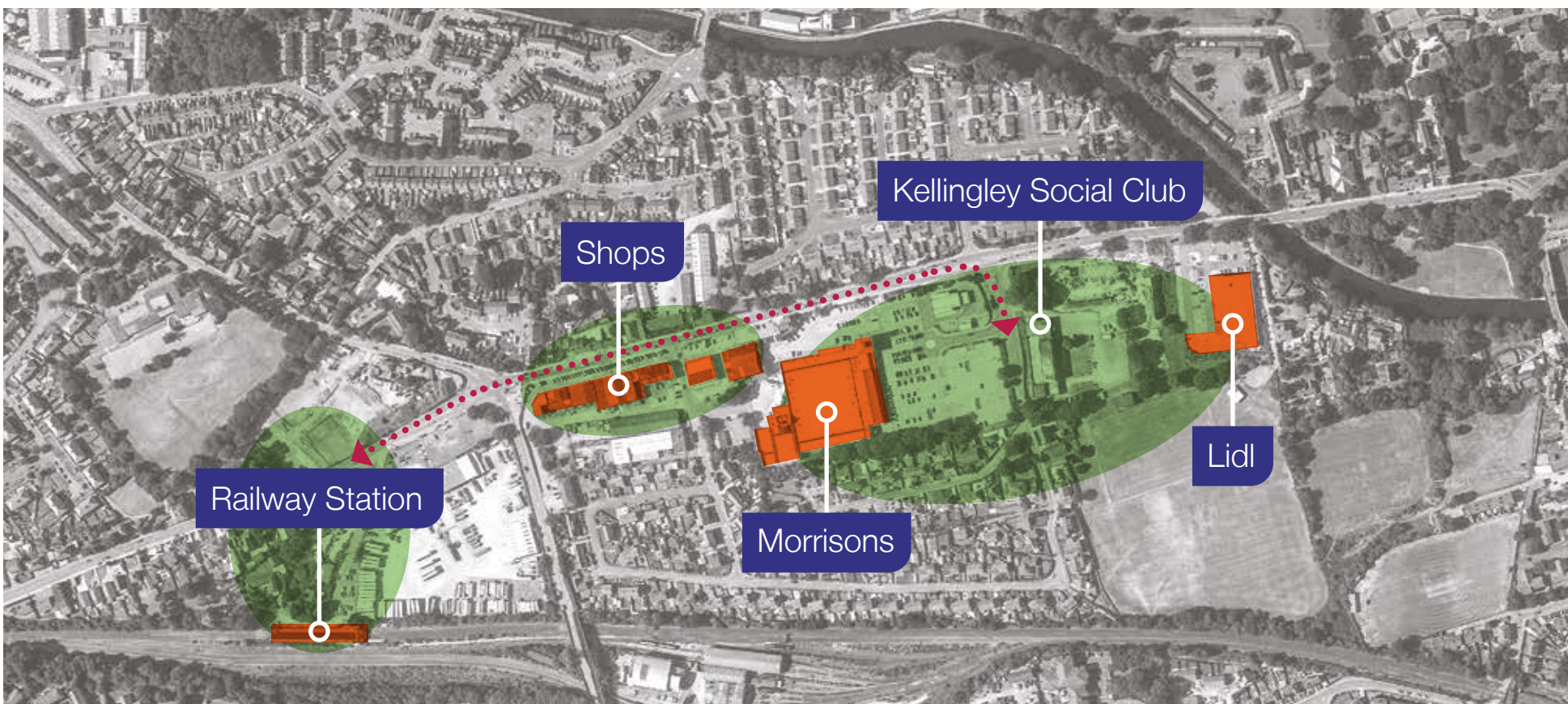

## Our Vision

### Indicative Illustration

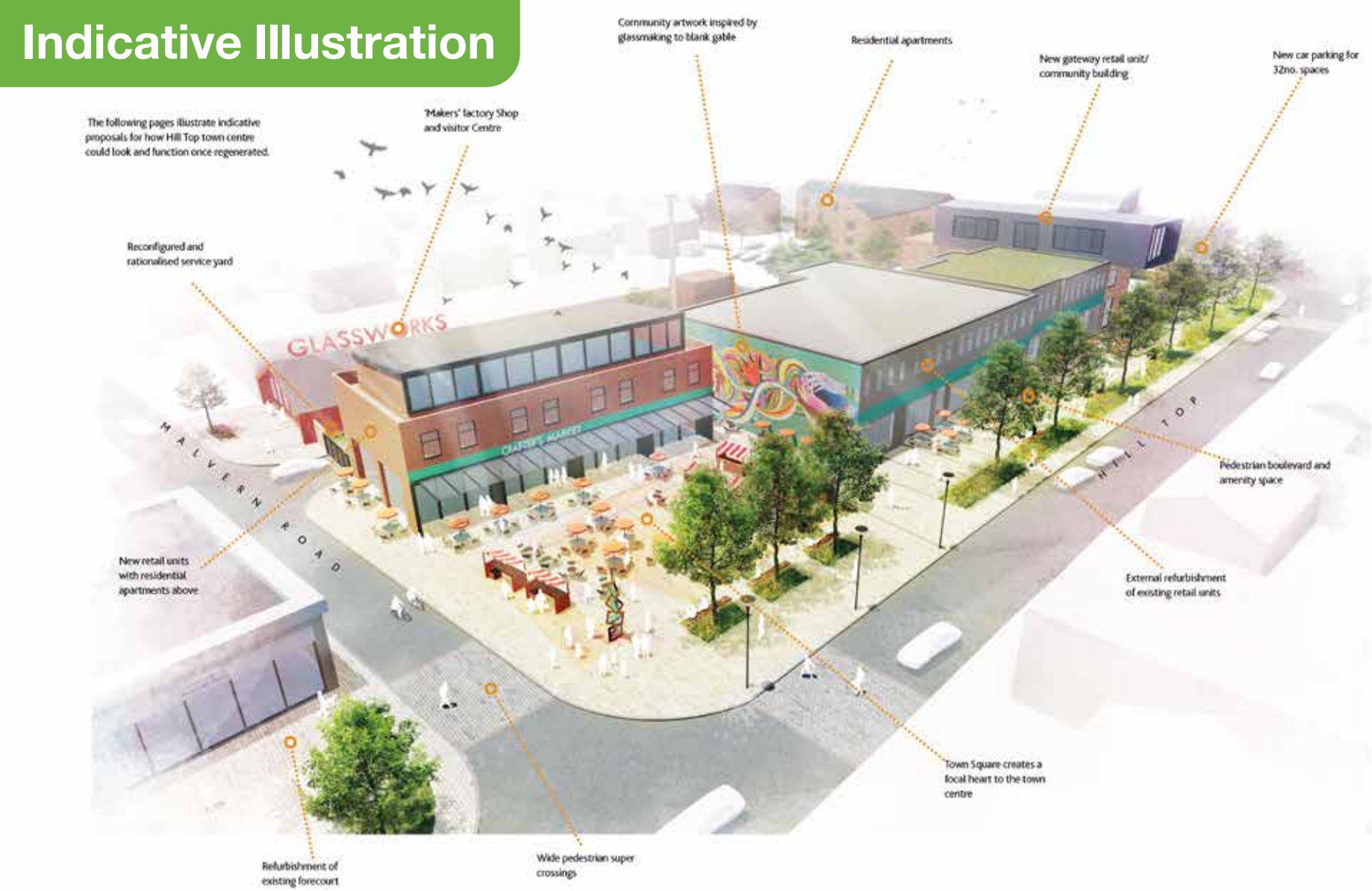

### Indicative Plan

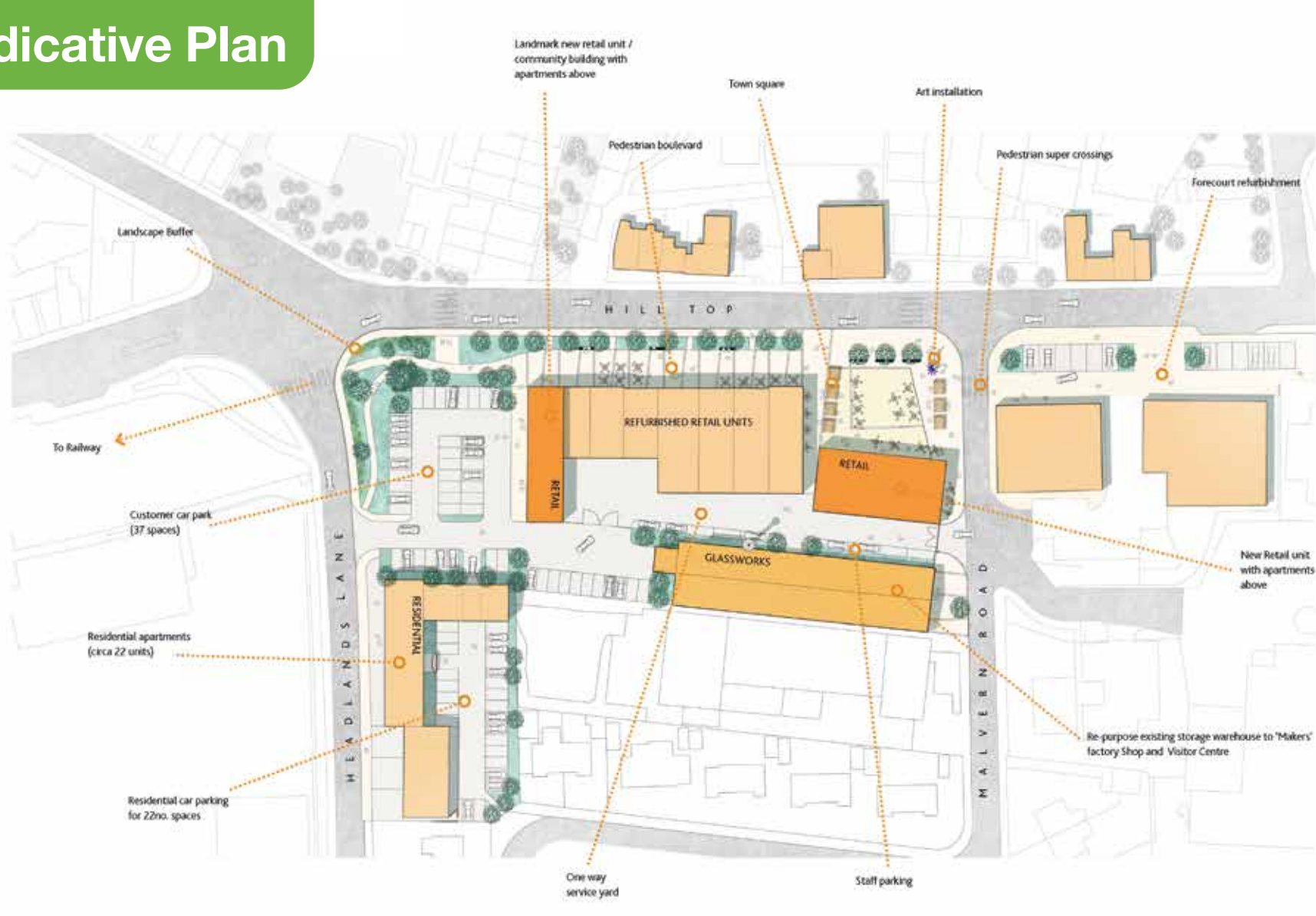

- |  |   |   |   |
|--|---|---|---|
|  Refurbishment of existing shops and their frontages                                    |  A reduction in through traffic  |  A key landmark and destination within the Masterplan area |  Greater access by foot and for cyclists           |
|  A new landmark building on the western approach to hill top                            |  Improved accessibility between the railway station and shopping areas |  Increased soft landscaping and trees                      |  Increased permeability with nearby neighbourhoods |
|  New residential properties on Headlands Lane   |  A new creative hub to showcase glassmaking                            |  Create a town square                                      |  A safe and well-lit environment                   |
|  Relocation of car parking to create an attractive space for people to meet on Hill Top |  A welcoming area and provision of places for people to meet and sit   |   |   |



# Knottingley and Ferrybridge

## Masterplan Consultation

4

### Link Road and Highways Improvements

The regeneration of Knottingley and Ferrybridge requires new highways infrastructure to enable the proposed scale of residential and commercial development to come forward. This is likely to take the form of a new link road working with Highways England, the Council's Highways Department and North Yorkshire Highways.

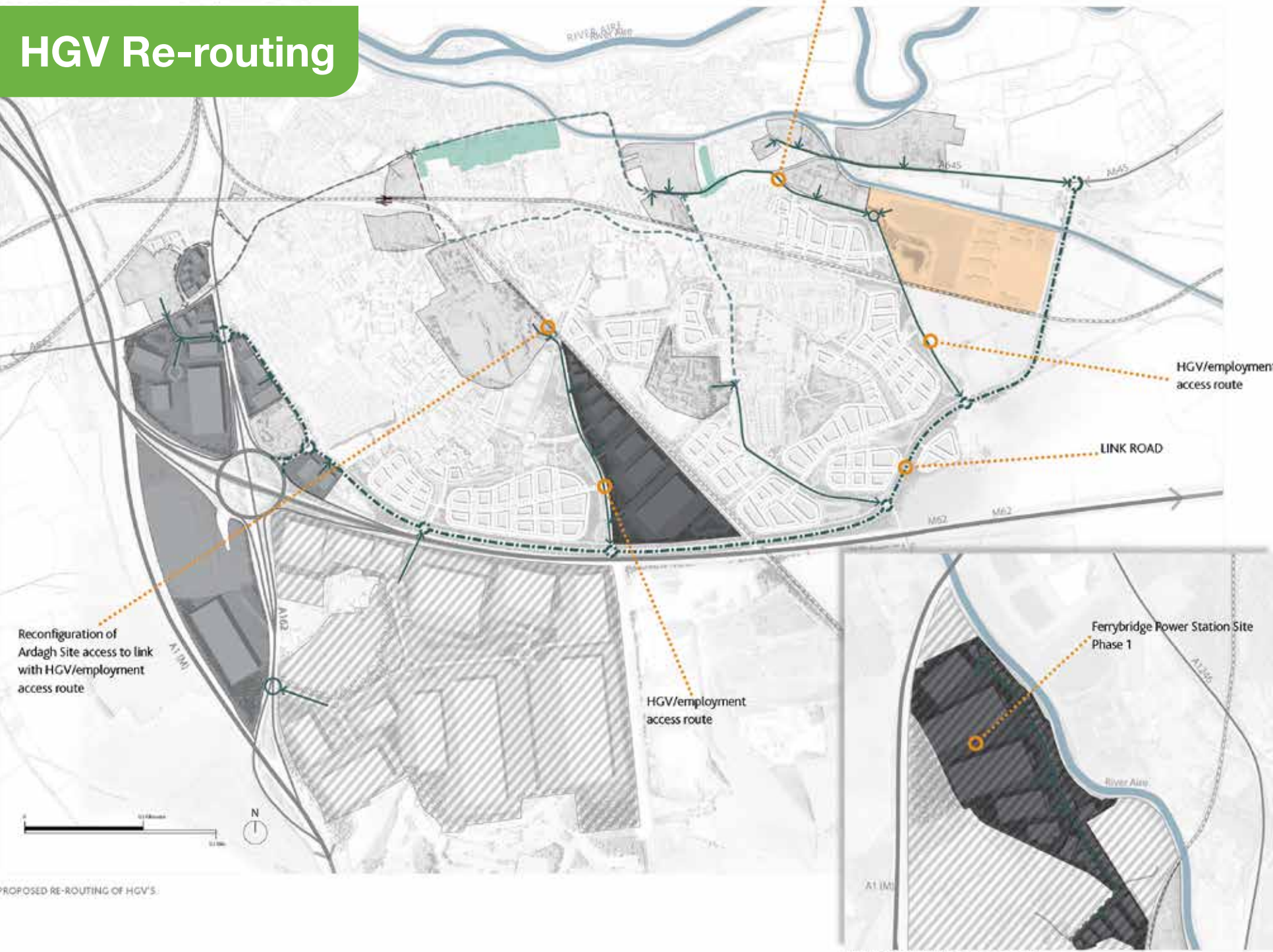
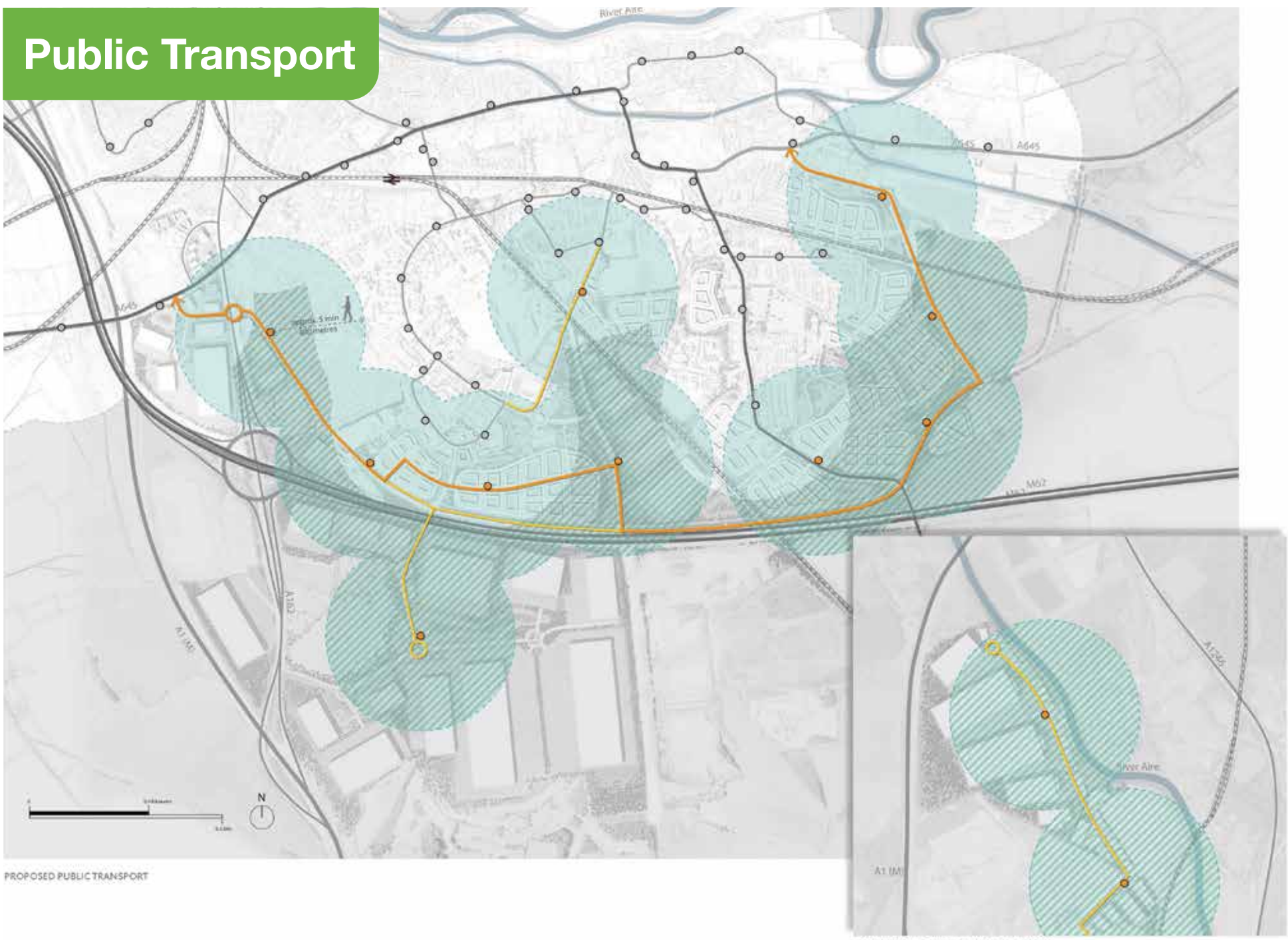
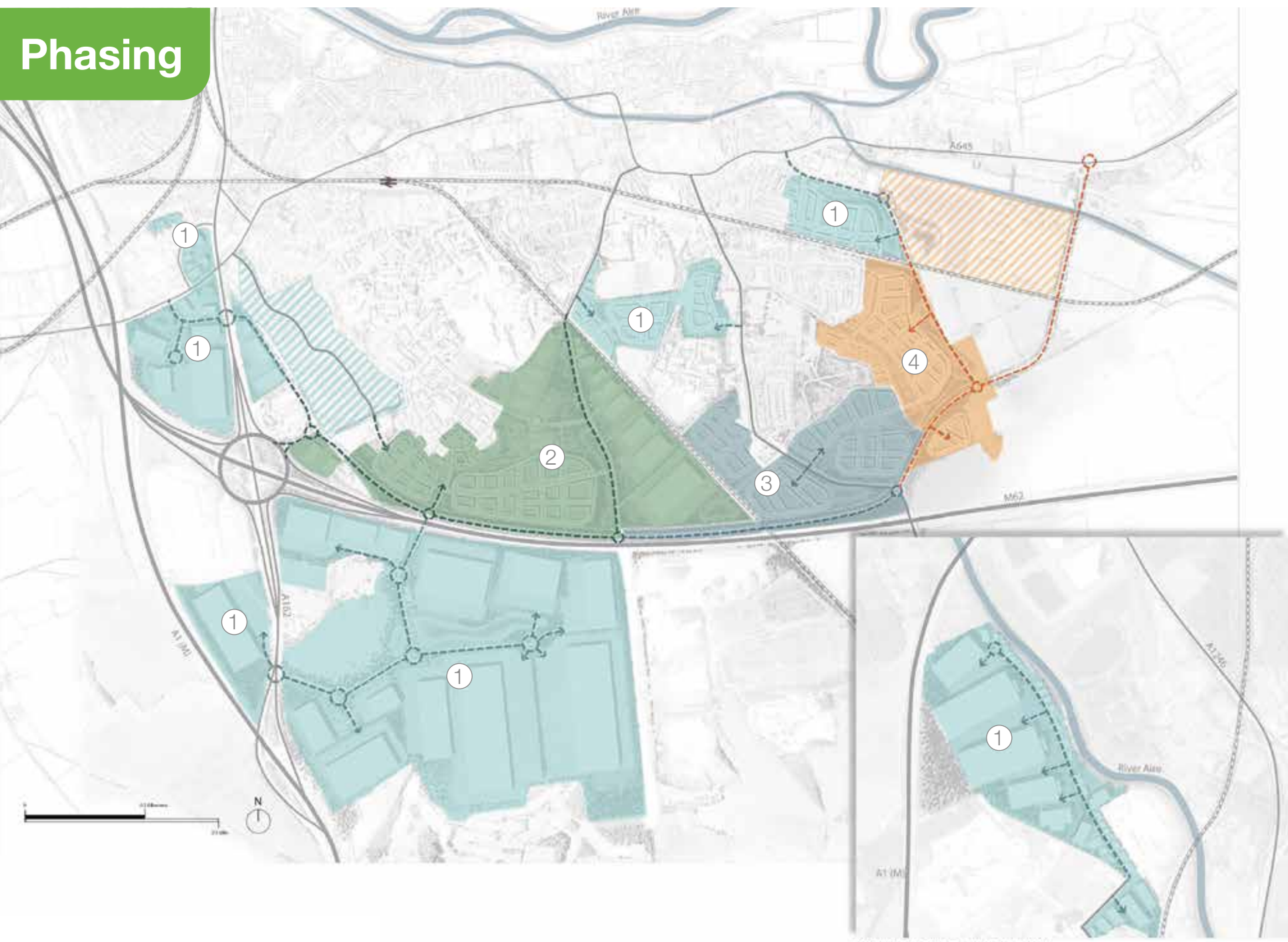

**What are its benefits?**

-  Will open up land for development
-  Will help remove heavy goods traffic from Hill Top
-  Help reduce noise and air pollution for existing residents
-  Will allow a new Town Centre to be brought forward
-  Increase access for pedestrians and cyclists
-  Will provide a more direct means of access to the road network for traffic serving the existing industrial sites

